

PPR PIPES & FITTINGS

PPR STOP VALVE

Colour- Green

Material – Polypropylene Random Copolymer (PPR)
& LFCR Brass

COMPLY WITH ISO 15874-2, 3 & 5
SS 375
AS/ NZS 4020
BS EN 12165

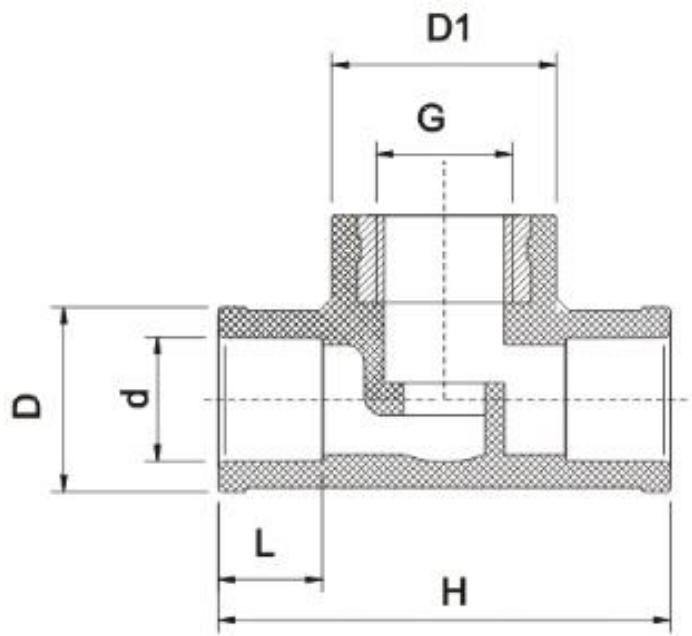

DIMENSIONS

SKU	D (mm)	d (mm)	L (mm)	G (mm)	H (mm)	D1 (mm)	Weight (kg)	PCS/CTN
PPRSV020	29.0	19.0	16.1	½"	70.7	34.8	0.157	48
PPRSV025	36.8	24.0	18.1	¾"	83.0	44.7	0.282	48
PPRSV032	43.4	30.9	20.1	¾"	86.5	45.2	0.300	32
PPRSV040	55.6	38.6	22.5	1"	97.4	55.5	0.421	30
PPRSV050	70.1	48.9	25.5	1 ¼"	121.6	66.3	0.689	24
PPRSV063	87.1	61.7	28.7	1 ½"	133.1	74.8	0.969	24
PPRSV075	103.2	73.4	32.0	2 ¼"	167.6	98.0	1.856	8
PPRSV090	123.6	88.8	36.0	2 ¾"	201.9	118.0	3.109	4
PPRSV110	149.5	107.5	42.0	3 ½"	245.6	147.0	5.122	2