

PPR PIPES & FITTINGS

PPR STOP VALVE WITH CHROME HANDLE

Colour- Green

Material – Polypropylene Random Copolymer (PPR)
& DZR Brass

COMPLY WITH ISO 15874-2, 3 & 5

SS 375

AS/ NZS 4020

BS EN 12165

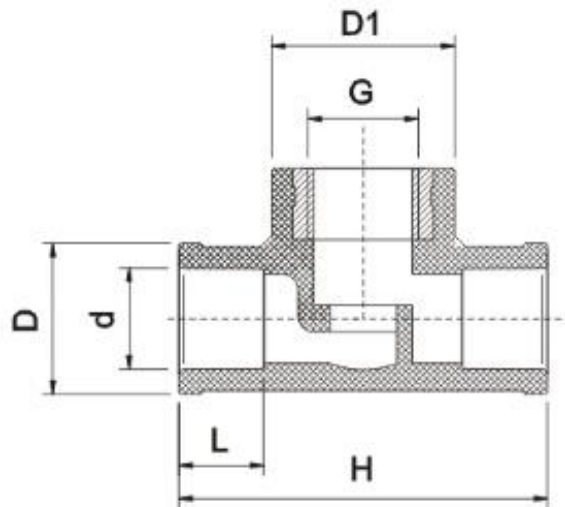

DIMENSIONS

| SKU | D (mm) | d (mm) | L (mm) | G (mm) | H (mm) | D1 (mm) | Weight (kg) | PCS/CTN |
|------------|--------|--------|--------|--------|--------|---------|-------------|---------|
| PPRSV020CP | 29.0 | 19.0 | 16.1 | ½" | 70.7 | 34.8 | 0.268 | 48 |
| PPRSV025CP | 36.8 | 24.0 | 18.1 | ¾" | 83.0 | 44.7 | 0.377 | 48 |
| PPRSV032CP | 43.4 | 30.9 | 20.1 | ¾" | 86.5 | 45.2 | 0.393 | 36 |